

MODELS:

PDU3VSR3H50, PDU3VSR10H50

3-Phase Switched Rackmount PDU



208V
3-Phase Input



Hubbell
CS8365C Plug



208V Single-
Phase Output



24 Outlets



C13



12.5kW Load
Capacity



Multimode
Load Meter



Network
Interface



OU
Rackmount



Toolless
Mounting
Buttons

- A** Digital Load Meter
- B** C13 and C19 Outlets with On/Off LEDs
- C** 20A 2-Pole Hydraulic Magnetic Circuit Breakers
- D** Removable Cord Retention Brackets
- E** Removable Mounting Brackets
- F** Toolless Mounting Buttons with Removable 90° Rotation Brackets
- G** PDU3VSR3H50: 3-ft. Input Power Cord
PDU3VSR10H50: 10-ft. Input Power Cord
- H** Hubbell CS8365C Twist-Lock Input Plug
- I** Durable Metal Case
- J** Network Interface
- K** RJ45 Ethernet Jack
- L** Manual Configuration Port
- M** Environmental Monitoring Port
- N** Network Interface Reset Button
- O** Modem Port (For Future Use)

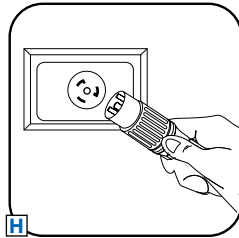

AC Input Connection: Insert Hubbell CS8365C twist-lock plug into compatible Hubbell CS8364C or CS8369 utility, generator or UPS outlet.

Also Includes: Cable Ties, Owner's Manual, PowerAlert Software CD-ROM

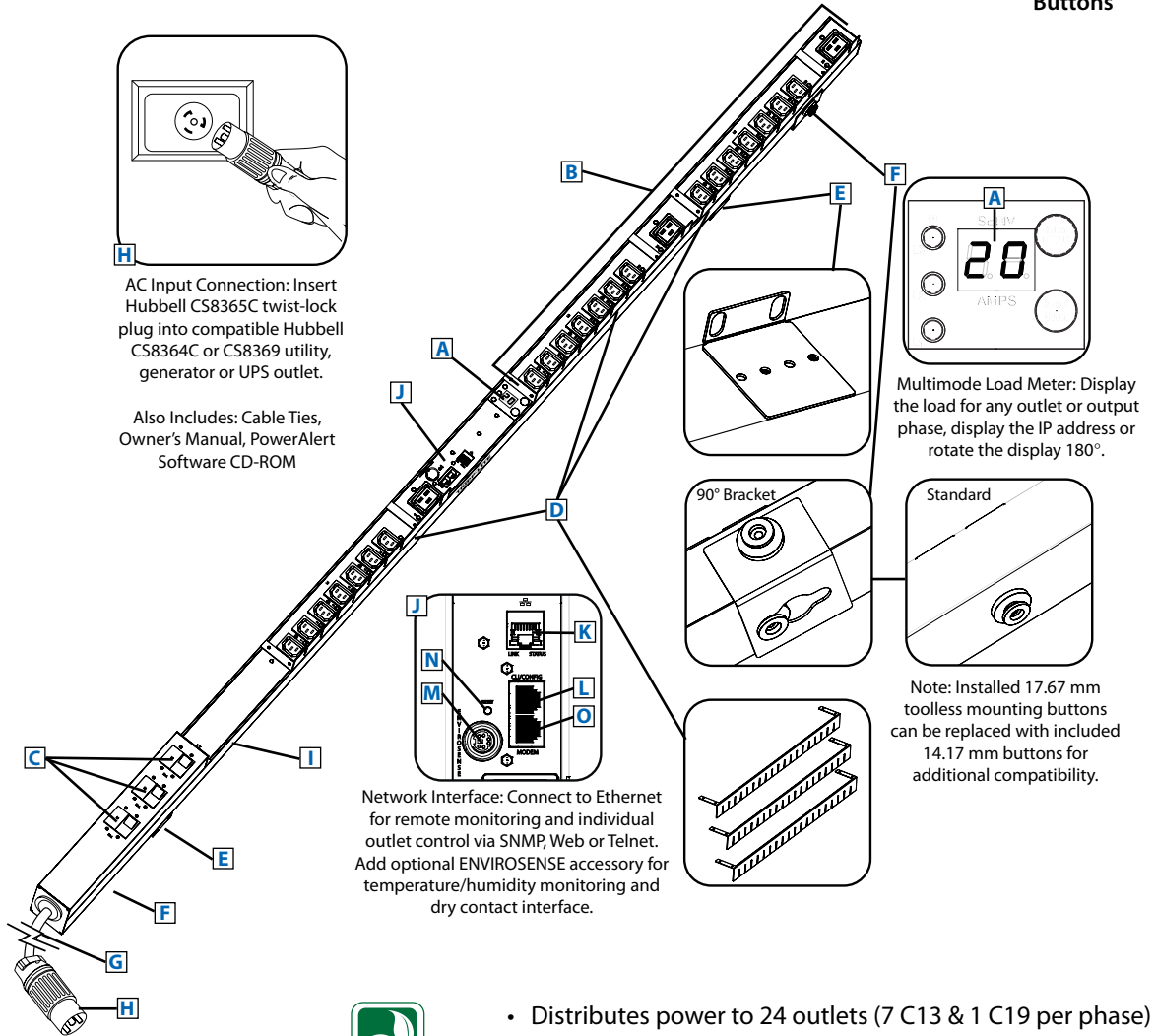

Network Interface: Connect to Ethernet for remote monitoring and individual outlet control via SNMP, Web or Telnet. Add optional ENVIROSENSE accessory for temperature/humidity monitoring and dry contact interface.

Multimode Load Meter: Display the load for any outlet or output phase, display the IP address or rotate the display 180°.

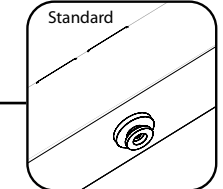

Note: Installed 17.67 mm toolless mounting buttons can be replaced with included 14.17 mm buttons for additional compatibility.



Specifications

Models	PDU3VSR3H50, PDU3VSR10H50
Voltage	208V (3-Phase Input/Single-Phase Output)
Frequency	50/60Hz
Load Capacity	12.5kW
Input Plug	Hubbell CS8365C (50A, 3-Pole, 4-Wire)
Input Cord Length	PDU3VSR3H50: 3 ft., PDU3VSR10H50: 10 ft.
Outlets	24 (21 C13 / 3 C19)
Primary Mounting Option	OU (Vertical) Rackmount
Unit Weight & Dimensions	PDU3VSR3H50: 14.6 lbs / 70 x 2.20 x 3.58 in., PDU3VSR10H50: 18.9 lbs / 70 x 2.20 x 3.58 in. See next page for detailed unit measurements.
Certifications	Tested to UL 60950-1 (US & Canada), NOM (Mexico), FCC Class A

Tripp Lite has a policy of continuous improvement. Specifications are subject to change without notice.

- Distributes power to 24 outlets (7 C13 & 1 C19 per phase)
- Remote monitoring and control via SNMP, Web or Telnet
- Displays load for *any outlet or output phase* in real time
- Perfect for rackmount server, network and telecom applications

SEE NEXT PAGE FOR DETAILED UNIT MEASUREMENTS



1111 W. 35th Street
Chicago, IL 60609 USA
773.869.1234
www.tripplite.com

