

PART NUMBER	REV	FIRST USED
567973-1	A	854040-3

638078 776093		VISIBLE PAD LTR	CRIMP DATA (AMP TERMINAL)
		A	CRIMP HEIGHT
		B	WIRE SIZE
		C	
		D	
		CRIMP	SIZE
		WIRE	TYPE
		INSUL	RANGE
WIRE STRIP LENGTH	TERM APPL SPEC	FEED	APPL INSTRUCTION
.188-.203	114-6066	.500	SEE CUSTOMER MANUAL
			SET UP GAGE
			NONE
			LAYOUT
			L1628

SIM TO HOM 680147

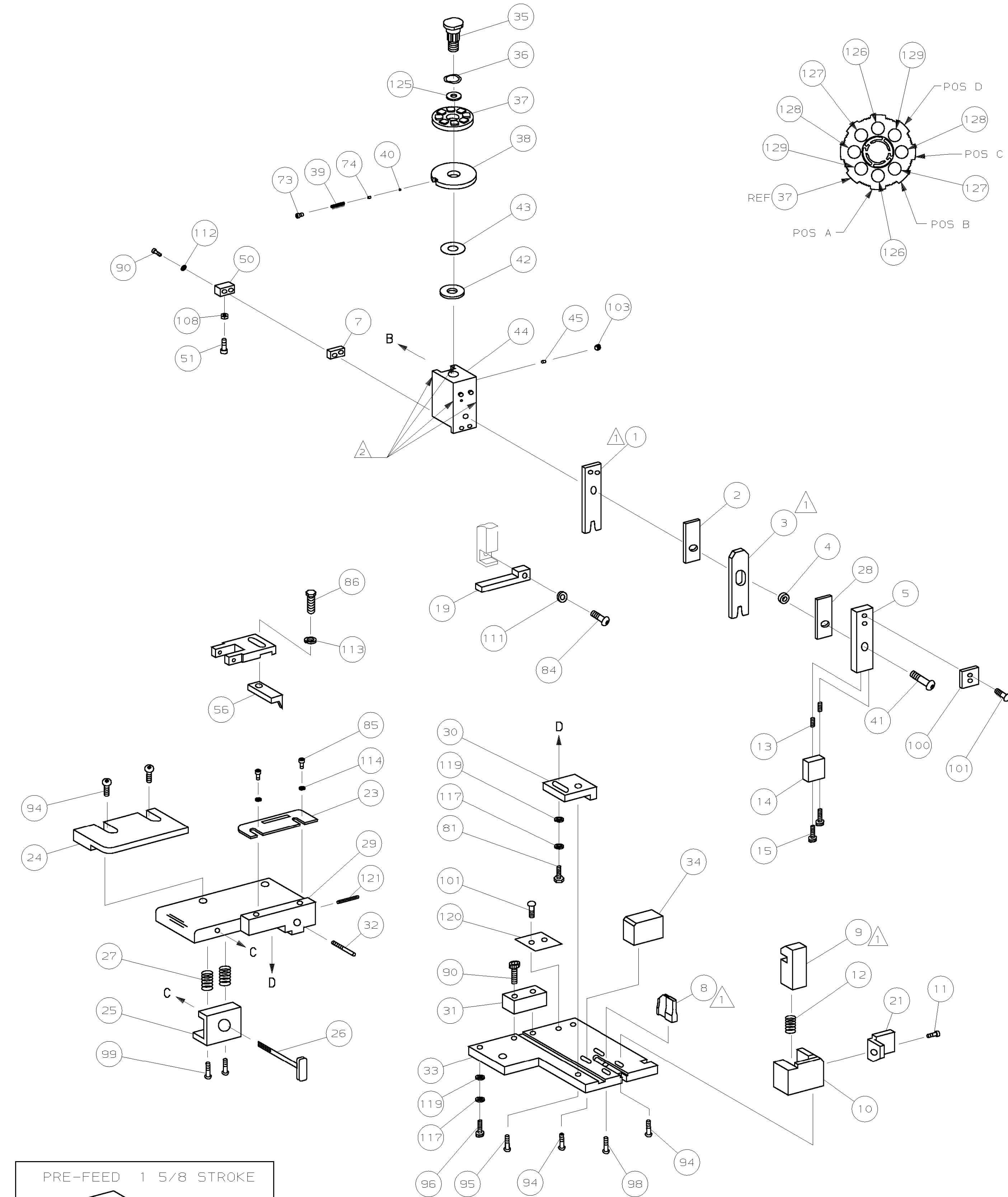

QTY	REV	TERM	APPL	SPEC	FEED	APPL INSTRUCTION	SET UP GAGE	LAYOUT
2	-	C	2-354779-9			PIN, WIRE DISC (.3135)D		129
2	-	C	1-354779-9			PIN, WIRE DISC (.3085)C		128
								127
2	-	C	4-354779-0			PIN, WIRE DISC (.3190)A		126
1	-	A	986950-1			WASHER, FLAT PRECISION		125
1	-	A	217238-3			GENERAL INSTRUCTION PACKAGE		124
								123
								122
1	-	A	4-21028-0			PIN, SLT SPR (Ø.093x.75) ST GDE PL		121
1	-	B	690701-2			PLATE, SERIAL NO.		120
2	-	A	21899-2			WASHER, FLAT (#10) S G ADJ BLK		119
								118
2	-	A	21024-5			WASHER, LOCK (#10) ADJ BLOCK		117
								116
								115
2	-	A	21024-2			WASHER, LOCK (#4) FRONT STP GUIDE		114
REF	-	A	21024-4			WASHER, LOCK (#8) FEED FINGER		113
2	-	A	21024-4			WASHER, LOCK (#8) DEP-HOLD		112
REF	-	A	21024-4			WASHER, LOCK (#8) STRIPPER		111
								110
								109
1	-	A	21018-5			NUT, HEX (#6) HOLD DOWN		108
								107
								106
								105
								104
1	-	A	21009-2			SCR, 5KT SET (1/4-20x.25 LW) RAM		103
								102
4	-	A	21017-2			SCR, DRIVE (#2x.19) ID PLATE		101
1	-	B	819347-1			PLATE, IDENTIFICATION		100
2	-	A	3-21002-0			SCR, BHC (10-32x.88) DRAG		99
1	-	A	22733-8			SCR, BHC (8-32x.38 LW) ANVIL		98
								97
1	-	A	3-21000-8			SCR, SHC (10-32x.88) MOUNTING		96
1	-	A	2-21002-7			SCR, BHC (10-32x.50) SG ADJ BLK		95
6	-	A	2-21002-2			SCR, BHC (8-32x.50) SHEAR-TERM SUP		94
								93
								92
1	-	A	1-21002-7			SCR, SHC (6-32x.50) CAM		91
4	-	A	2-21000-7			SCR, SHC (8-32x.50) SCR BLK		90
								89
								88
								87
REF	-	A	2-22603-0			SCR, HEX HD (8-32x.31) FEED FINGER		86
2	-	A	1-21000-3			SCR, SHC (4-40x.25) F ST GUIDE		85
REF	-	A	22733-9			SCR, BHC (8-32x.50 SL) STRIPPER		84
								83
								82
1	-	A	3-22603-1			SCR, HEX (10-32x.38) SG ADJ BL		81
								80
								79
								78
2	-	B	463310-3			BLADE, STRIPPING (#16)		77
								76
								75
1	-	A	690603-1			SPRING, ASSIST		74
1	-	A	23030-1			SCR, 5KT CAP (6-32x.25) CP DSC		73
								72
								71

QTY	REV	U/M	DWG SIZE	PART NO	DESCRIPTION	ITEM NO
-1		U/M	DWG SIZE	PART NO	DESCRIPTION	ITEM NO

QTY	REV	U/M	DWG SIZE	PART NO	DESCRIPTION	ITEM NO
						70
						69
						68
						67
						66
						65
						64
						63
						62
						61
						60
						59
						58
						57
REF	-	B		694433-8	PAWL, FEED	56
						55
						54
						53
						52
1	-	A		811242-2	BUMPER, HOLDDOWN	51
1	-	A		690753-1	SPACER, TONKER	50
						49
1	-	A		690602-6	CAM, PRE-FEED 1.62 STROKE	48
						47
						46
1	-	A		690191-1	PLUG, NYLON	45
1	-	C		455673-1	RAM	44
1	-	A		690125-1	WASHER, LAMINATED	43
1	-	A		690124-1	WASHER, RAM	42
1	-	A		690686-3	BOLT, CRIMPER (5/16x1.00)	41
1	-	A		23241-6	BALL, STEEL	40
1	-	A		690170-1	SPRING, COMPRESSION	39
1	-	C		690142-1	DISC, INSULATION	38
1	-	D		354777-1	WIRE DISC, PLASTIC	37
1	-	A		22480-5	WASHER, SPRING	36
1	-	B		690212-1	POST, RAM	35
1	-	B		1-690786-4	SUPPORT, TERMINAL	34
1	-	C		462544-1	PLATE, BASE SPECIAL	33
1	-	A		690432-3	SCREW, ADJUSTMENT	32
1	-	B		462543-1	BLOCK, SCREW SPECIAL	31
1	-	B		455689-1	BLOCK, STRIP GUIDE ADJ	30
1	-	C		455671-1	PLATE, STRIP GUIDE	29
1	-	C		455888-1	SPACER, FRONT SHEAR DEP	28
2	-	A		1-22284-0	SPRING, DRAG	27
1	-	B		690546-1	LEVER, DRAG RELEASE	26
1	-	B		240792-1	DRAG, TERMINAL	25
1	-	D		7-690504-6	GUIDE, STRIP (REAR)	24
1	-	A		690438-1	GUIDE, STRIP (FRONT)	23
						22
1	-	A		463756-1	GUIDE, SCRAP	21
						20
REF	-	C		462615-1	STRIPPER	19
1	-	B		904225-1	JAW ASSY	18
						17
						16
2	-	A		1-21989-4	SCR, SHLD	15
1	-	B		904274-2	DEPRESSOR	14
2	-	A		6-22281-3	SPRING, DEPRESSOR	13
1	-	A		5-22280-0	SPRING, SHEAR	12
1	-	B		690461-2	STOP, SHEAR (FRONT)	11
1	-	B		462548-1	HOLDER, SHEAR (FRONT) SP	10
1	-	B		462547-1	SHEAR, FLOAT (FRONT) SP	9
1	-	C		2-189717-1	ANVIL	8
1	-	C		1-240641-0	SPACER, DEPRESSOR (REAR)	7
						6
1	-	A		904273-1	DEPRESSOR, SHEAR (FRONT) SP	5
1	-	B		1-238011-0	SPACER, BLOCK CRIMPER	4
1	-	C		4-456135-2	CRIMPER, INSULATION	3
1	-	C		455888-9	SPACER, CRIMPER	2
1	-	C		2-456407-0	CRIMPER, WIRE	1

QTY	REV	U/M	DWG SIZE	PART NO	DESCRIPTION	ITEM NO
-1		U/M	DWG SIZE	PART NO	DESCRIPTION	ITEM NO

PRE-FEED 1 5/8 STROKE

ROTATED 180°

RECOMMENDED SPARE PARTS.
GREASE LIGHTLY.
ITEM NOT SHOWN

QTY	REV	U/M	DWG SIZE	PART NO	DESCRIPTION	ITEM NO
-1		U/M	DWG SIZE	PART NO	DESCRIPTION	ITEM NO

DIMENSIONS IN INCHES. DO NOT SCALE PRINT. TOLERANCES UNLESS OTHERWISE SPECIFIED.

2 PLC DEC ±
3 PLC DEC ±
4 PLC DEC ±
ANGLES ±
SURF TEXTURE: ✓
REMOVE BURRS, BREAK SHARP EDGES R.015 MAX

MATL - HT TR - FIN -

DR 22MAR01 APP 23MAR01
R.O.WILSON T.ELBIN

CHK 22MAR01 REL -
R.O.WILSON

AMP AMP Incorporated
Harrisburg, PA 17105-3608

NAME STRIPPER CRIMPER APPLICATOR MACHINE REF STRIPPER CRIMPER

SCALE - DWG NO 567973 SHEET 1 OF 1 REV A

CASE CODE 00779 CUSTOMER AND ASSEMBLY DRAWING RESTRICTED TO

THIS DRAWING IS A CONTROLLED DOCUMENT.

THIS DRAWING IS UNRELEASED. RELEASED FOR PUBLICATION BY AMP INCORPORATED. ALL RIGHTS RESERVED. LOC A DIST 66