

PART NUMBER	REV	FIRST USED
567975-1	A	854040-3

TERMINAL NAME: ERNI TERMINAL		CRIMP DATA (NON-AMP TERM-CUST SPEC)	
AMP	MF6 P/N	CRIMP HEIGHT	WIRE SIZE
286977	014729	A .027 ±.002 [0.69 ±0.05mm]	20
		B .025 ±.002 [0.64 ±0.05mm]	22
		C NOT	USED
		D NOT	USED
WIRE STRIP LENGTH	TERM APPL SPEC	FEED	APPL INSTRUCTION
.115	NONE	.300	SEE CUSTOMER MANUAL
WIRE	CRIMP	SIZE	TYPE
		.055 [1.40mm]	F
INSUL	CRIMP	SIZE	TYPE
		.062 [1.57mm]	0
			.060 MAX
WIRE STRIP LENGTH	TERM APPL SPEC	FEED	APPL INSTRUCTION
.115	NONE	.300	SEE CUSTOMER MANUAL
SET UP GAGE	LAYOUT		
NONE	L2552		

QTY	REV	U/M	DWG SIZE	PART NO	DESCRIPTION	ITEM NO
1	-	A		694433-8	PAWL, FEED	56
1	-	A		811242-2	BUMPER, HOLDDOWN	51
1	-	A		690753-1	SPACER, TONKER	50
1	-	A		690602-6	CAM, PRE-FEED 1.62 STROKE	48
1	-	A		690191-1	PLUG, NYLON	45
1	-	C		455673-3	RAM	44
1	-	A		690125-1	WASHER, LAMINATED	43
1	-	A		690124-9	WASHER, RAM	42
1	-	A		7-21002-9	BOLT, CRIMPER (5/16x1.00)	41
1	-	A		23241-6	BALL, STEEL	40
1	-	A		690170-1	SPRING, COMPRESSION	39
1	-	C		690142-1	DISC, INSULATION	38
1	-	D		354777-1	WIRE DISC, PLASTIC	37
1	-	A		22480-5	WASHER, SPRING	36
1	-	B		690212-1	POST, RAM	35
1	-	B		690786-4	SUPPORT, TERMINAL	34
1	-	C		462544-1	PLATE, BASE SPECIAL	33
1	-	A		690432-3	SCREW, ADJUSTMENT	32
1	-	B		462543-1	BLOCK, SCREW SPECIAL	31
1	-	B		455689-1	BLOCK, STRIP GUIDE ADJ	30
1	-	C		455671-3	PLATE, STRIP GUIDE	29
1	-	C		1-455888-1	SPACER, FRONT SHEAR DEP	28
2	-	A		1-22284-0	SPRING, DRAG	27
1	-	B		690546-1	LEVER, DRAG RELEASE	26
1	-	B		240792-1	DRAG, TERMINAL	25
1	-	D		6-690504-4	GUIDE, STRIP (REAR)	24
1	-	A		690438-1	GUIDE, STRIP (FRONT)	23
1	-	A		463756-1	GUIDE, SCRAP	21
1	-	A		5-22280-0	SPRING, SHEAR	12
1	-	B		1-690461-6	STOP, SHEAR (FRONT)	11
1	-	B		462548-1	HOLDER, SHEAR (FRONT) SP	10
1	-	B		462547-1	SHEAR, FLOAT (FRONT) SP	9
1	-	C		1-662183-9	ANVIL	8
1	-	C		2-240641-4	SPACER, DEPRESSOR (REAR)	7
1	-	A		462838-1	DEPRESSOR, SHEAR (FRONT) SP	5
1	-	B		2-238011-0	SPACER, BLOCK CRIMPER	4
1	-	C		5-456135-7	CRIMPER, INSULATION	3
1	-	C		4-456402-5	CRIMPER, WIRE	1

QTY	REV	U/M	DWG SIZE	PART NO	DESCRIPTION	ITEM NO
2	-	C		6-354779-8	PIN, WIRE DISC (.3330)D	129
2	-	C		6-354779-4	PIN, WIRE DISC (.3310)C	128
1	-	A		986950-1	WASHER, FLAT PRECISION	125
1	-	A		217238-3	GENERAL INSTRUCTION PACKAGE	124
1	-	A		4-21028-0	PIN, SLT SPR (ø.093x.75) ST 60E PL	121
1	-	B		690701-2	PLATE, SERIAL NO.	120
2	-	A		21899-2	WASHER, FLAT (#10) 5 G ADJ BLK	119
2	-	A		21024-5	WASHER, LOCK (#10) ADJ BLOCK	117
2	-	A		21024-2	WASHER, LOCK (#4) FRONT STP GUIDE	114
REF	-	A		21024-4	WASHER, LOCK (#8) FEED FINGER	113
2	-	A		21024-4	WASHER, LOCK (#8) DEP-HOLD	112
REF	-	A		21024-4	WASHER, LOCK (#8) STRIPPER	111
1	-	A		21018-5	NUT, HEX (#6) HOLD DOWN	108
1	-	A		21009-2	SCR, SKT 5ET (1/4-20x.25 LW) RAM	103
4	-	A		21017-2	SCR, DRIVE (#2x.19) ID PLATE	101
1	-	B		819347-1	PLATE, IDENTIFICATION	100
2	-	A		3-21002-0	SCR, BHC (10-32x.88) DRAG	99
1	-	A		22733-8	SCR, BHC (8-32x.38 LW) ANVIL	98
1	-	A		3-21000-8	SCR, SHC (10-32x.88) MOUNTING	96
1	-	A		2-21002-7	SCR, BHC (10-32x.50) 5G ADJ BLK	95
6	-	A		2-21002-2	SCR, BHC (8-32x.50) SHEAR-TERM SUP	94
1	-	A		1-21002-7	SCR, SHC (6-32x.50) CAM	91
2	-	A		2-21000-7	SCR, SHC (8-32x.50) SCR BLK	90
2	-	A		2-21000-8	SCR, SHC (8-32x.62) DEP-HOLD DOWN	87
REF	-	A		2-22603-0	SCR, HEX HD (8-32x.31) FEED FINGER	86
2	-	A		1-21000-3	SCR, SHC (4-40x.25) F ST GUIDE	85
REF	-	A		22733-9	SCR, BHC (8-32x.50 SL) STRIPPER	84
1	-	A		3-22603-1	SCR, HEX (10-32x.38) 5G ADJ BL	81
2	-	B		463310-5	BLADE, STRIPPING (#20)	77
1	-	A		690603-1	SPRING, ASSIST	74
1	-	A		23030-1	SCR, SKT CAP (6-32x.25) CP DSC	73

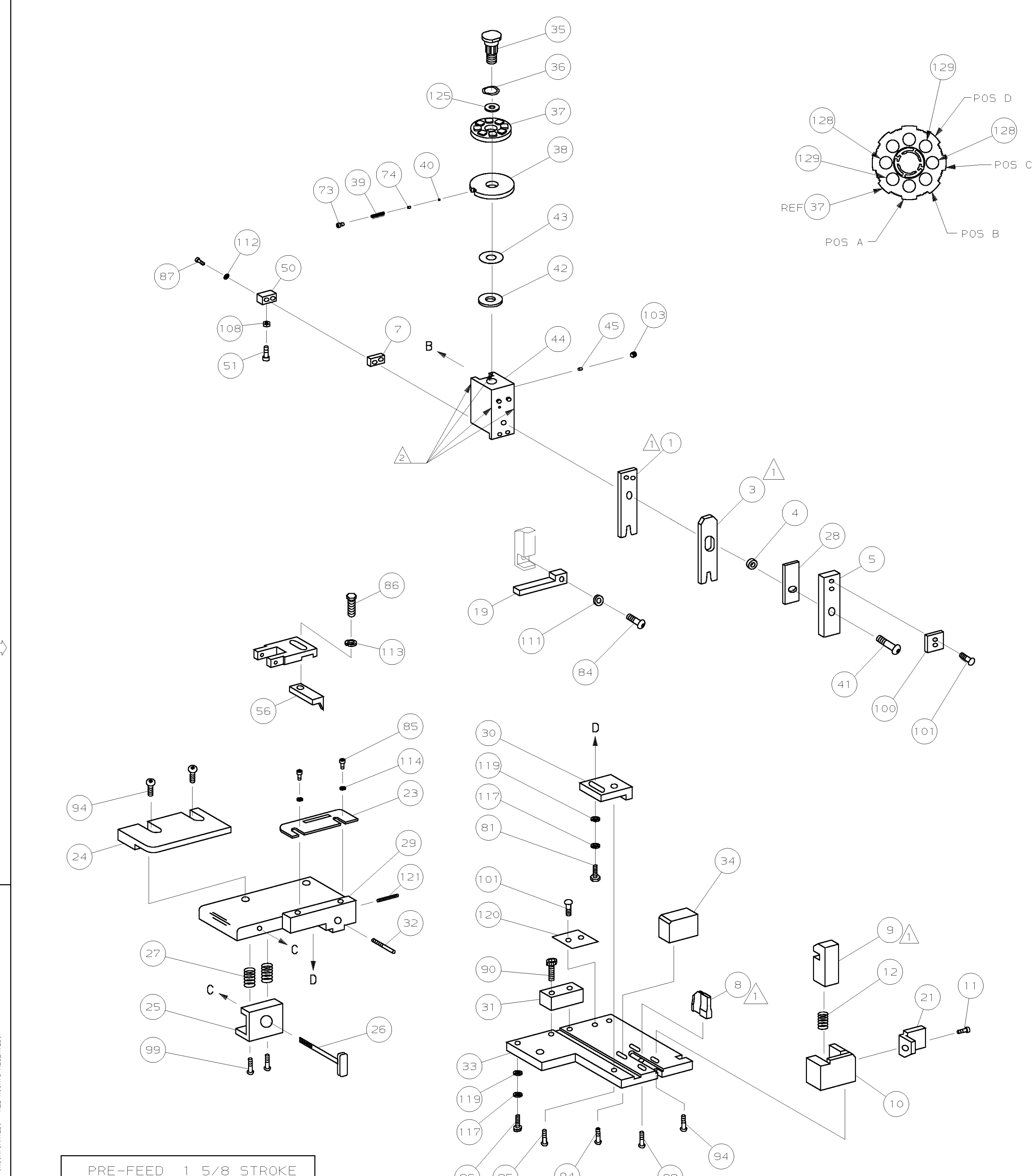

1 RECOMMENDED SPARE PARTS.
 2 GREASE LIGHTLY.
 3 ITEM NOT SHOWN

QTY	REV	U/M	DWG SIZE	PART NO	DESCRIPTION	ITEM NO
1	-	A		463310-5	BLADE, STRIPPING (#20)	77

QTY	REV	U/M	DWG SIZE	PART NO	DESCRIPTION	ITEM NO
1	-	A		4-456402-5	CRIMPER, WIRE	1